

**MK5102**

MKT3028BBPKG/G/0.3M/ZH/ASR

Magnetic sensors, cylinder sensors

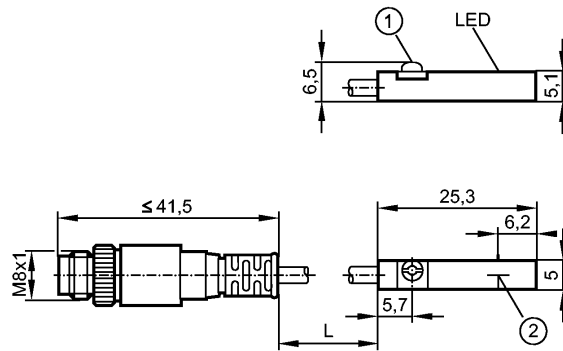

- 1: Fastening clamp
- 2: sensing face

Made in Germany



**Product characteristics**

cylinder sensor with GMR cell

Plastic housing for T-slot cylinders

Cable with connector

[f] flush mountable

Magnetic sensitivity 2.8 mT

Travel speed > 10 m/s

**Electrical data**

Electrical design		DC PNP
Operating voltage	[V]	10...30 DC
Current consumption	[mA]	< 10
Protection class		III
Reverse polarity protection		yes
Power-on delay time	[ms]	< 30

**Outputs**

Output function		normally open
Voltage drop	[V]	< 2.5
Current rating	[mA]	100
Short-circuit protection		pulsed
Overload protection		yes
Switching frequency	[Hz]	10000

**Range**

Magnetic sensitivity	[mT]	2.8
Travel speed	[m/s]	> 10

**Accuracy / deviations**

Hysteresis	[mm]	< 1.5
Repeatability	[mm]	< 0.2

**Environment**

Ambient temperature	[°C]	-25...85
Protection		IP 65 / IP 67

**Tests / approvals**

EMC	EN 61000-4-2 ESD:	- CD / 8 kV AD
	EN 61000-4-3 HF radiated:	10 V/m (80...2000 MHz)

**MK5102**

MKT3028BBPKG/G/0.3M/ZH/ASR

Magnetic sensors, cylinder sensors

	EN 61000-4-4 Burst:	2 kV
	EN 61000-4-6 HF conducted:	10 V (0.15...80 MHz)
	EN 55011:	class B
MTTF	[Years]	3694

**Mechanical data**

Mounting	flush mountable
Housing materials	housing: PA (polyamide); Fastening clamp: stainless steel
Weight	[kg] 0.015

**Displays / operating elements**

Output status indication	LED	yellow
--------------------------	-----	--------

**Electrical connection**

Connection	PUR cable / 0.3 m; with M8 connector, with turnable coupling ring
------------	---

**Wiring**

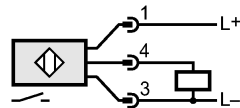
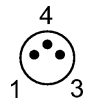

**Accessories**

Accessories (included)	rubber placeholder; cable clip
------------------------	--------------------------------

**Remarks**

Remarks	cULus - Class 2 source required Clamping screw with combined slot/hexagon socket head AF 1.5
---------	---

Pack quantity	[piece] 1
---------------	-----------