

OGS300

OGS-00KG/US100

Photoelectric sensors

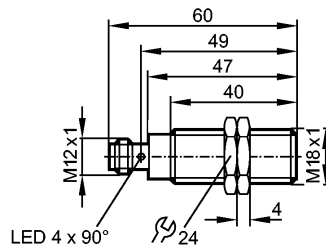

Made in Germany



Product characteristics

Through-beam sensor
Threaded type
M18 x 1
Connector
Transmitter
Sensing range 20m

Electrical data

Electrical design	DC
Operating voltage [V]	10...36 DC
Current consumption [mA]	15
Type of light	Red light 624 nm
Protection class	II
Reverse polarity protection	yes

Range

Sensing range [m]	20
Light spot diameter [mm]	800 (at maximum range)

Excess gain graphs

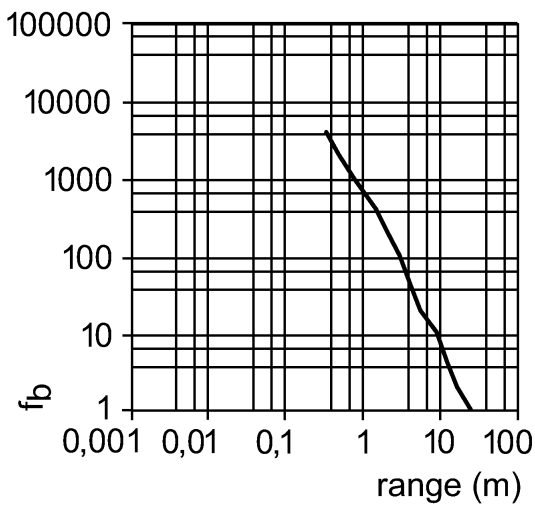

Environment

Ambient temperature [°C]	-25...80
Protection	IP 67 / IP 68 / IP 69K

Tests / approvals

EMC	EN 60947-5-2
MTTF [Years]	755

OGS300

OGS-OOKG/US100

Photoelectric sensors

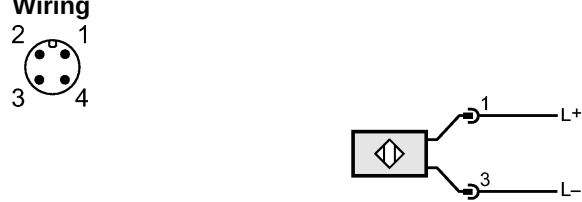
Mechanical data	
Housing materials	housing: stainless steel 316L / 1.4404; sealing: EPDM
Lens material	PMMA
Weight [kg]	0.056
Displays / operating elements	
Operation	LED green
Electrical connection	
Connection	M12 connector
Wiring 	
Accessories	
Accessories (included)	2 lock nuts
Remarks	
Remarks	cULus - Class 2 source required
Pack quantity [piece]	1